

SD52C

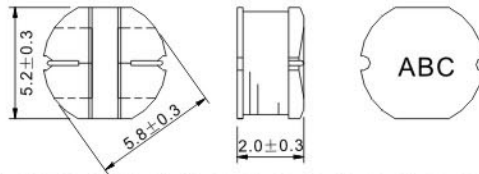

Dimensions 外形尺寸图(mm)



Land patterns 贴装尺寸(mm)

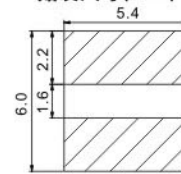

Construction/磁气构造图 Unshield/开磁



FEATURES:

- ▶ Quantity/reel:2,500PCS.
- ▶ Small product,rotundity 5.8mm type (6.1mm Maximum) Height 2.0mm TYP.
- ▶ Carrier tape packing, use for SMT.
- ▶ Suitable for reflow soldering.
- ▶ Widely use in DC-DC converter/LCD TV/Notebook/PDA/MP3-MP4 player/Digital camera/Portable CDR-W etc.

特长:

- ▶ 数量/卷: 2,500PCS。
- ▶ 产品小型化, 圆形5.8mm(6.1mm Max)高度2.0mm TYP。
- ▶ 使用载带包装运用于SMT。
- ▶ 适用于回流焊SMT工艺。
- ▶ 广泛应用于升降压转换器、液晶显示、笔记本电脑、个人掌上记事本、MP3/MP4播放器、数码相机、便携式光碟机等。

Electrical Characteristics/电气特性

Model No. 部品名	Test Condition 测试条件	Inductance 电感(μH)	Tolerance 公差(%)	DC resistance 直流电阻 MAX(Ω)	Rated current 额定电流(A)
SD52C-1R0MC	100KHz,0.3V	1.0	±20	0.05	4.2
SD52C-2R2MC	100KHz,0.3V	2.2	±20	0.08	3.2
SD52C-3R3MC	100KHz,0.3V	3.3	±20	0.12	2.4
SD52C-3R9MC	100KHz,0.3V	3.9	±20	0.14	2.0
SD52C-4R7MC	100KHz,0.3V	4.7	±20	0.15	1.8
SD52C-5R6MC	100KHz,0.3V	5.6	±20	0.16	1.5
SD52C-6R8MC	100KHz,0.3V	6.8	±20	0.17	1.4
SD52C-8R2MC	100KHz,0.3V	8.2	±20	0.20	1.3
SD52C-100MC	1KHz,0.3V	10	±20	0.23	1.1
SD52C-120MC	1KHz,0.3V	12	±20	0.25	1.05
SD52C-150MC	1KHz,0.3V	15	±20	0.30	1.00
SD52C-180MC	1KHz,0.3V	18	±20	0.35	0.90
SD52C-220MC	1KHz,0.3V	22	±20	0.40	0.85
SD52C-270MC	1KHz,0.3V	27	±20	0.50	0.75
SD52C-330MC	1KHz,0.3V	33	±20	0.55	0.70
SD52C-390MC	1KHz,0.3V	39	±20	0.65	0.60
SD52C-470MC	1KHz,0.3V	47	±20	0.75	0.55
SD52C-560MC	1KHz,0.3V	56	±20	0.95	0.50
SD52C-680MC	1KHz,0.3V	68	±20	1.20	0.45
SD52C-820MC	1KHz,0.3V	82	±20	1.40	0.40
SD52C-101MC	1KHz,0.3V	100	±20	1.75	0.35
SD52C-121MC	1KHz,0.3V	120	±20	2.00	0.25
SD52C-151MC	1KHz,0.3V	150	±20	2.60	0.22
SD52C-181MC	1KHz,0.3V	180	±20	3.70	0.18
SD52C-221MC	1KHz,0.3V	220	±20	4.00	0.19
SD52C-271MC	1KHz,0.3V	270	±20	4.20	0.20

Inductance Range/电感范围: 1.0~270 μH
Temperature Range/使用温度: -30~100°C

RoHS Compliant(SGS Certified Result) 本产品满足环境保护要求(有害物质限用)					
Pb 铅	Cd 镉	Hg 汞	六价铬 Cr ⁶⁺	多溴联苯 PBBs	多溴联苯醚 PBDEs
<1000ppm	Nd	Nd	Nd	Nd	Nd

- (1) Inductance is measured with a LCR meter: HP4284A(Agilent)/3532-50(HIOKI) or equivalent. Test frequency at 100kHz/1KHz.
- (2) DC resistance is measured with a Digital Multimeter TH2512B(TongHui) or equivalent.
- (3) The DC Bias test with TH2817&TH1775(TongHui) The maximum allowable current is a DC current which causes initial inductance to decrease by 25%, or temperature to rise by 40°C, whichever is smaller. (At ambient reference temperature:20°C)

- (1) 电感值测试仪:HP4284A(Agilent)/3532-50(HIOKI)或同等LCR Meter。测试频率100KHz/1KHz。
- (2) 直流电阻测试仪:TH2512B或同等的DCR测试设备。
- (3) 最大容许电流测试:TH2817&TH1775;最大容许电流定义:电感下降25%或温度上升40°C时取其小值作为最大容许电流。(周围环境温度20°C)

Packaging /包装方式

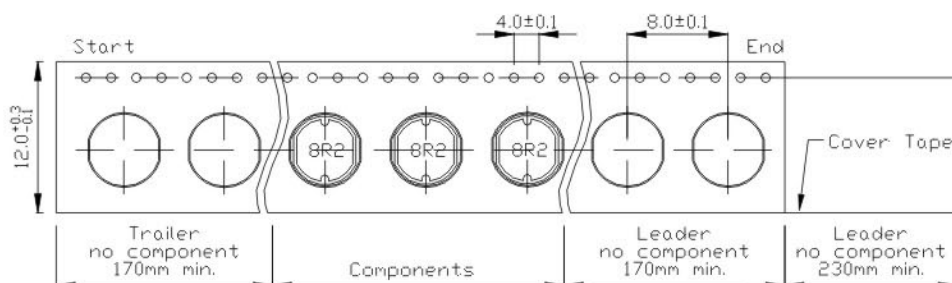

2000PCS/REEL
2REEL/内盒
5内盒/箱

净重: 6.34KG/箱
毛重: 12.04KG/箱